

# Speedway Plaza

7730 BRUTON SMITH BLVD, CONCORD, NC 28027



Retail / Medical

FOR SIZE PRICE  
| Lease | 14,030 SF | \$27 psf NNN + TICAM \$3.92 psf



## Overview

1st floor space available

Units D: 5,065 SF available

2nd floor space available immediately

Unit 2A: 3,900 SF move in ready

Unit 2B: 2,400 SF empty shell

Unit 2C: 2,665 SF empty shell

Elevator and (2) staircase access to 2nd floor

76 parking spaces

Located across from Concord Mills and Great Wolf Lodge

Excellent visibility from Bruton Smith Boulevard

I-85 152,000 AADT (2021)

Bruton Smith Blvd 22,500 AADT (2022)

## Retail and Medical Space Available for Lease



Rebecca Herron  
Director of  
Office & Industrial  
(704) 367 5017  
rherron@mpvre.com

Robbie Adams  
Director of Retail  
(704) 248 2108  
radams@mpvre.com

2400 South Boulevard | Suite 300  
Charlotte, NC 28203

mpvre.com

# Speedway Plaza

7730 BRUTON SMITH BLVD, CONCORD, NC 28027

## Property Overview

### Demographics

Source: Esri® 2023

|                | 1 mile   | 3 mile    | 5 mile    |
|----------------|----------|-----------|-----------|
| Population     | 939      | 46,976    | 160,050   |
| Growth Rate    | 0.43%    | 2.65%     | 2.12%     |
| Avg. HH Income | \$86,091 | \$112,603 | \$110,233 |

### Traffic Count

Source: NCDOT

|                   | AADT          |
|-------------------|---------------|
| Bruton Smith Blvd | 22,500 (2022) |

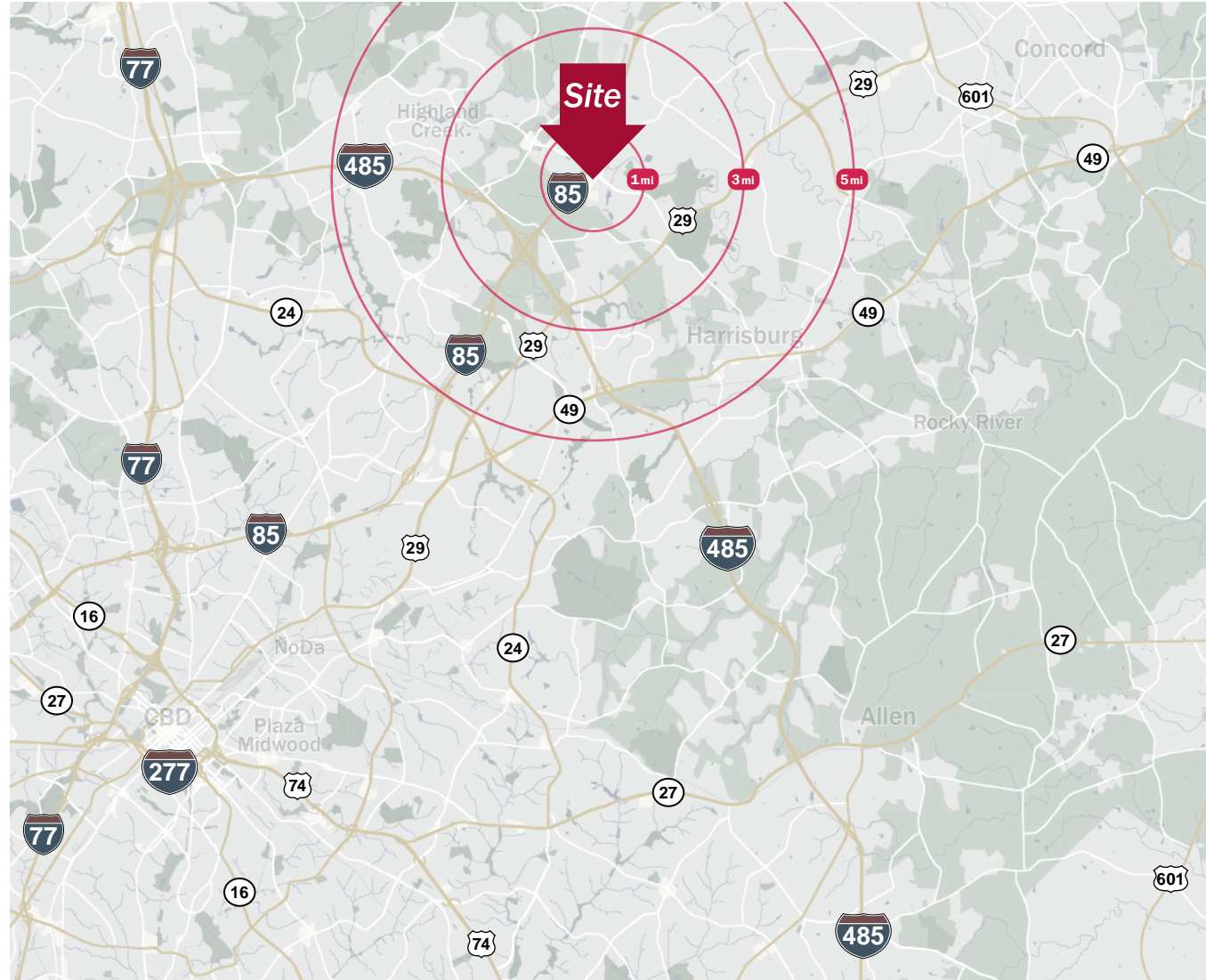

Rebecca Herron  
Director of  
Office & Industrial  
(704) 367 5017  
rherron@mpvre.com

Robbie Adams  
Director of Retail  
(704) 248 2108  
radams@mpvre.com

2400 South Boulevard | Suite 300  
Charlotte, NC 28203

[mpvre.com](http://mpvre.com)

# Speedway Plaza

7730 BRUTON SMITH BLVD, CONCORD, NC 28027

## Site Plan

First Floor Availability

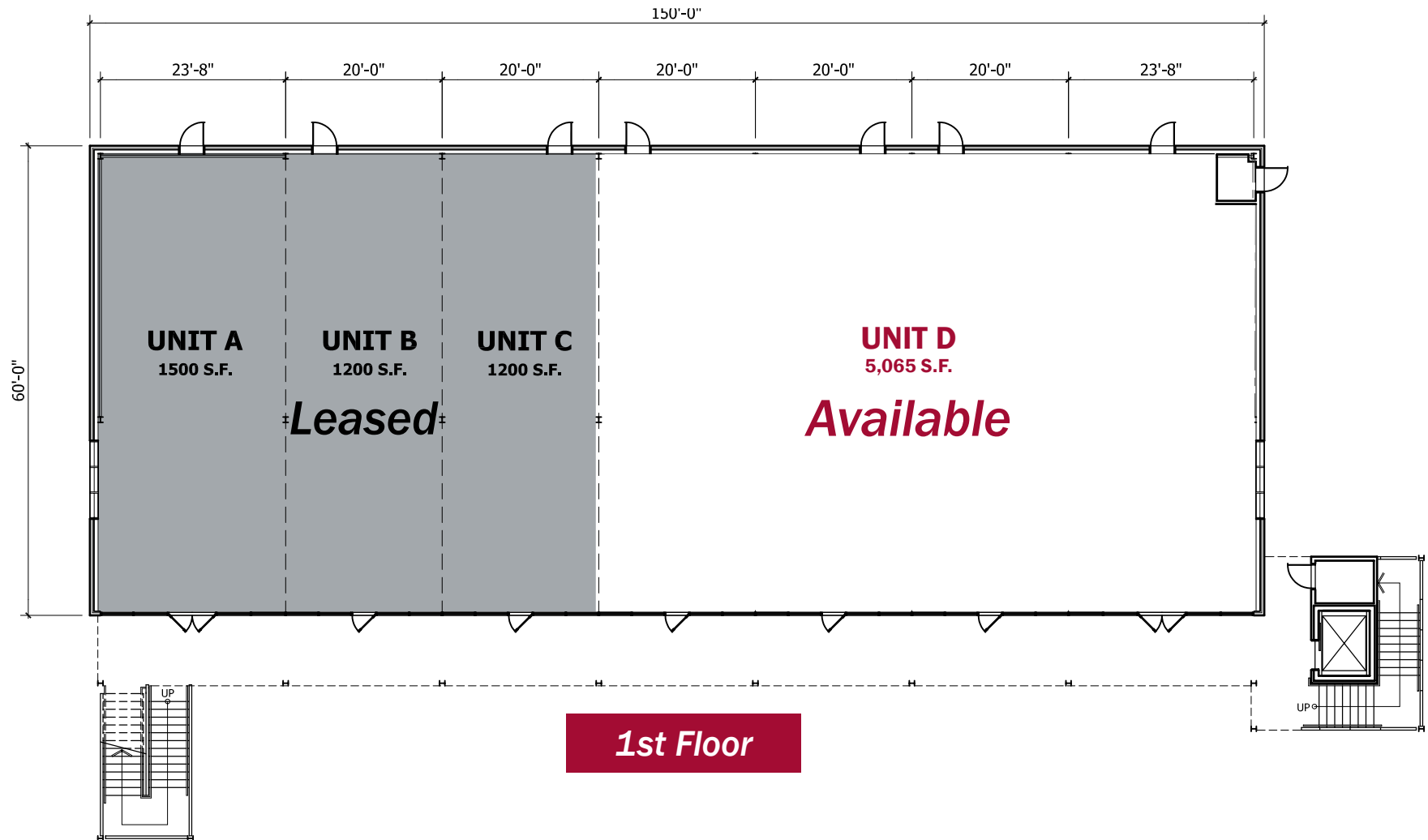

Rebecca Herron  
Director of  
Office & Industrial  
(704) 367 5017  
rherron@mpvre.com

Robbie Adams  
Director of Retail  
(704) 248 2108  
radams@mpvre.com

2400 South Boulevard | Suite 300  
Charlotte, NC 28203

[mpvre.com](http://mpvre.com)

# Speedway Plaza

7730 BRUTON SMITH BLVD, CONCORD, NC 28027

## Site Plan

Second Floor Availability

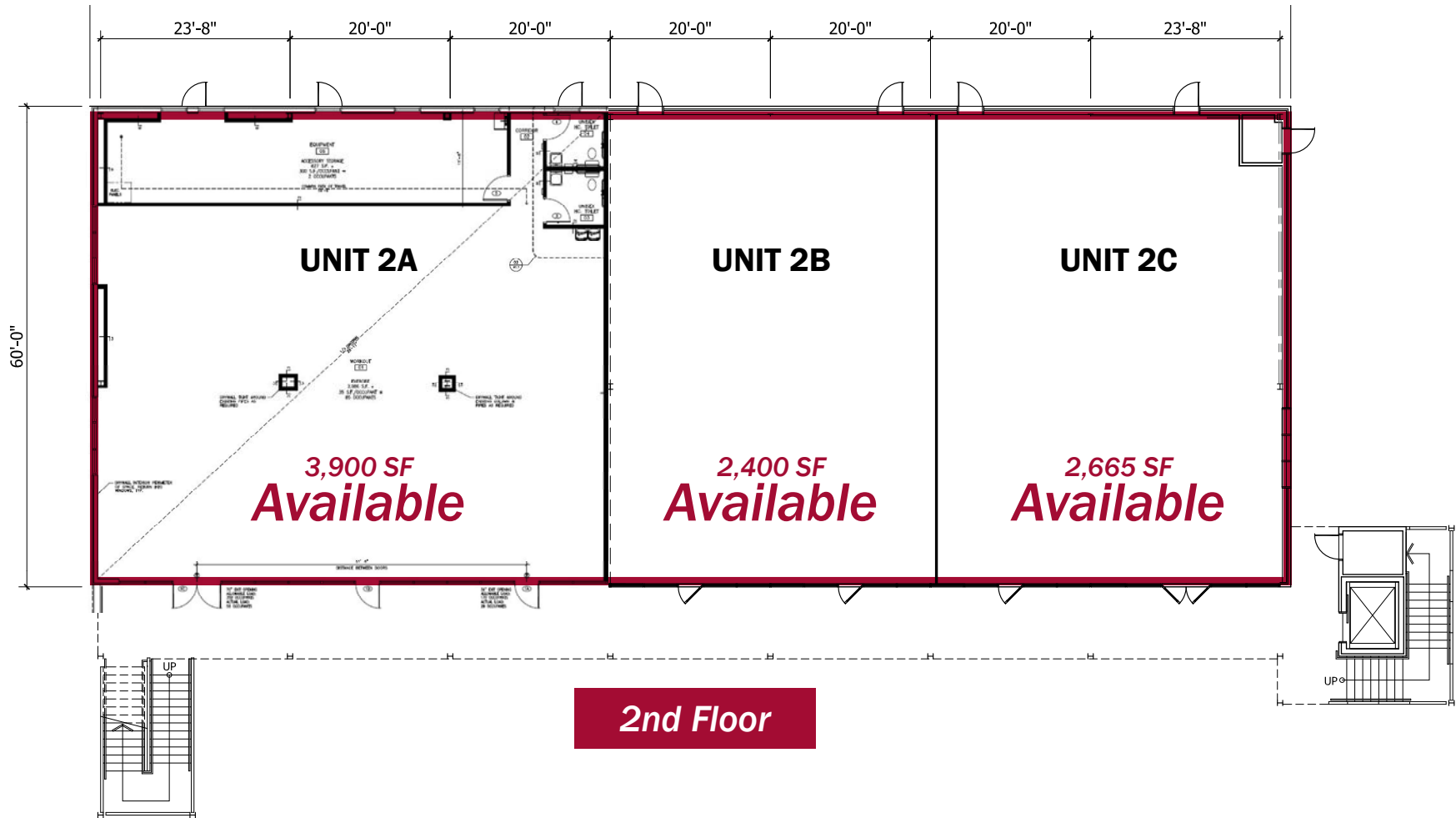

Rebecca Herron  
Director of  
Office & Industrial  
(704) 367 5017  
rherron@mpvre.com

Robbie Adams  
Director of Retail  
(704) 248 2108  
radams@mpvre.com

2400 South Boulevard | Suite 300  
Charlotte, NC 28203

[mpvre.com](http://mpvre.com)



# Speedway Plaza

7730 BRUTON SMITH BLVD, CONCORD, NC 28027

## Market Aerial

Nearby retail & residential activity



Rebecca Herron  
Director of  
Office & Industrial  
(704) 367 5017  
rherron@mpvre.com

Robbie Adams  
Director of Retail  
(704) 248 2108  
radams@mpvre.com

2400 South Boulevard | Suite 300  
Charlotte, NC 28203

mpvre.com



# Speedway Plaza

7730 BRUTON SMITH BLVD, CONCORD, NC 28027

## Nearby Retail



This GIS data is deemed reliable but provided "as is" without warranty of any representation of accuracy, timeliness, reliability or completeness. This map document does not represent a legal survey of the land and is for graphical purposes only. Use of this data for any purpose should be of acknowledgment of the limitations of the data, including the fact that the data is dynamic and is in a constant state of maintenance, correction, and update.



Rebecca Herron  
Director of  
Office & Industrial  
(704) 367 5017  
rherron@mpvre.com

Robbie Adams  
Director of Retail  
(704) 248 2108  
radams@mpvre.com

2400 South Boulevard | Suite 300  
Charlotte, NC 28203

mpvre.com



# Speedway Plaza

7730 BRUTON SMITH BLVD, CONCORD, NC 28027

## Property Photos

2nd Floor, Unit A



Front Entrance

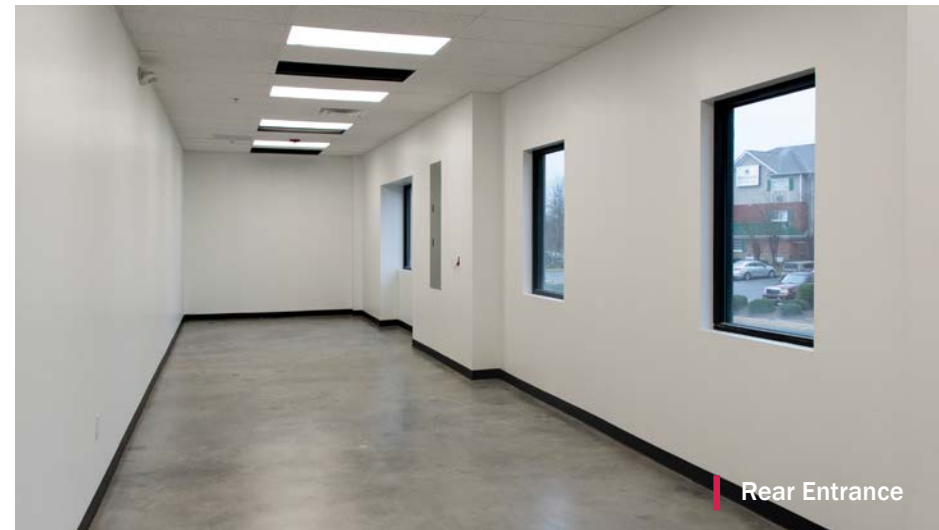

Rear Entrance



Rebecca Herron  
Director of  
Office & Industrial  
(704) 367 5017  
rherron@mpvre.com

Robbie Adams  
Director of Retail  
(704) 248 2108  
radams@mpvre.com

2400 South Boulevard | Suite 300  
Charlotte, NC 28203







[mpvre.com](http://mpvre.com)

# Speedway Plaza

7730 BRUTON SMITH BLVD, CONCORD, NC 28027

## Void Analysis

\*Source: Placer.ai

| Chains  | Typical Drive Time (min) | Nearest Location (mi) | # of Venues           | Expansion Rate            | Relative Fit Score |
|---|--------------------------|-----------------------|-----------------------|---------------------------|--------------------|
|  <b>Marlow's Tavern</b><br>Restaurants, American Resta...            | N/A                      | 213.8 mi              | State / US<br>0 / 19  | State / US<br>0% / 0%     | 100%               |
|  <b>Torchy's Tacos</b><br>Restaurants, Mexican Restau...             | 17 min                   | 121.5 mi              | State / US<br>1 / 105 | State / US<br>0% / -0.94% | 99.6%              |
|  <b>Willy's Mexicana Grill</b><br>Fast Food & QSR, Burrito Place     | 15 min                   | 182.1 mi              | State / US<br>0 / 28  | State / US<br>0% / 0%     | 98.7%              |
|  <b>Atlanta Bread Company</b><br>Breakfast, Coffee, Bakeries &...    | N/A                      | 101 mi                | State / US<br>2 / 14  | State / US<br>0% / -6.67% | 98.2%              |
|  <b>la Madeleine Country ...</b><br>Restaurants, French Restaura...  | 14 min                   | 207 mi                | State / US<br>0 / 91  | State / US<br>0% / 1.11%  | 97.2%              |
|  <b>Pita Mediterranean St...</b><br>Restaurants, Mediterranean ... | 20 min                   | 96.2 mi               | State / US<br>0 / 32  | State / US<br>0% / 0%     | 97.1%              |
|  <b>Run On</b><br>Recreational & Sporting Good...                  | N/A                      | 118.9 mi              | State / US<br>2 / 67  | State / US<br>0% / 0%     | 97.1%              |



Rebecca Herron  
Director of  
Office & Industrial  
(704) 367 5017  
rherron@mpvre.com

Robbie Adams  
Director of Retail  
(704) 248 2108  
radams@mpvre.com

2400 South Boulevard | Suite 300  
Charlotte, NC 28203

mpvre.com









# Speedway Plaza

7730 BRUTON SMITH BLVD, CONCORD, NC 28027

## Void Analysis

\*Source: Placer.ai

| Chains  | Typical Drive Time (min) | Nearest Location (mi) | # of Venues           | Expansion Rate                | Relative Fit Score |
|---|--------------------------|-----------------------|-----------------------|-------------------------------|--------------------|
|  <b>LaVida Massage</b><br>Beauty & Spa, Spa / Massage        | 11 min                   | 21.2 mi               | State / US<br>5 / 50  | State / US<br>0% / -1.96%     | 97%                |
|  <b>Burger 21</b><br>Fast Food & QSR, Burger Joint           | N/A                      | 23 mi                 | State / US<br>1 / 15  | State / US<br>-50% / -6.25%   | 97%                |
|  <b>Image Studios 360</b><br>Beauty & Spa, Salon / Barber... | 14 min                   | 12.5 mi               | State / US<br>4 / 62  | State / US<br>33.33% / 16.98% | 96.8%              |
|  <b>Sleep Experts</b><br>Home Improvement, Mattres...        | 17 min                   | 911.4 mi              | State / US<br>0 / 31  | State / US<br>0% / -6.06%     | 96.7%              |
|  <b>Massage Green Spa</b><br>Beauty & Spa, Massage Studio    | 12 min                   | 294.2 mi              | State / US<br>0 / 45  | State / US<br>0% / 2.27%      | 96.7%              |
|  <b>Pie Five Pizza Co.</b><br>Fast Food & QSR, Pizza Place | 13 min                   | 110.9 mi              | State / US<br>0 / 31  | State / US<br>0% / 0%         | 96.3%              |
|  <b>Massage Heights</b><br>Beauty & Spa, Massage Studio    | 13 min                   | 13 mi                 | State / US<br>2 / 106 | State / US<br>0% / -1.85%     | 96.2%              |



Rebecca Herron  
Director of  
Office & Industrial  
(704) 367 5017  
rherron@mpvre.com

Robbie Adams  
Director of Retail  
(704) 248 2108  
radams@mpvre.com

2400 South Boulevard | Suite 300  
Charlotte, NC 28203

mpvre.com

# Speedway Plaza

7730 BRUTON SMITH BLVD, CONCORD, NC 28027

## Daily Visits

\*Source: Placer.ai

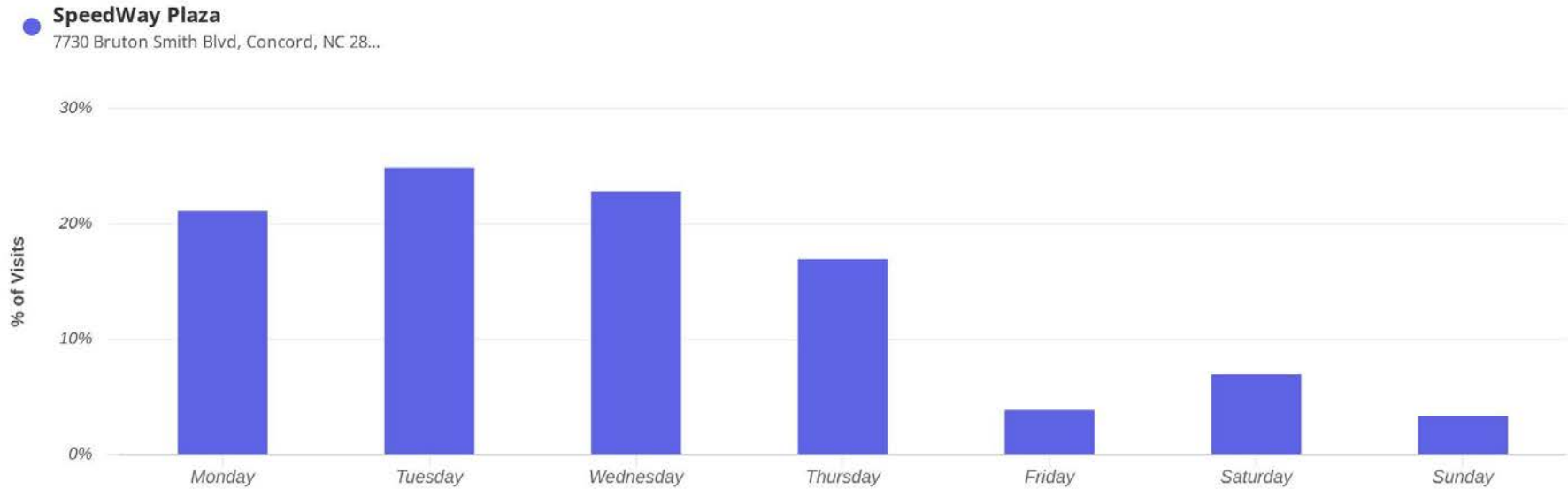

**Rebecca Herron**  
Director of  
Office & Industrial  
(704) 367 5017  
rherron@mpvre.com

**Robbie Adams**  
Director of Retail  
(704) 248 2108  
radams@mpvre.com

2400 South Boulevard | Suite 300  
Charlotte, NC 28203

[mpvre.com](http://mpvre.com)



# Speedway Plaza

7730 BRUTON SMITH BLVD, CONCORD, NC 28027

## Hourly Visits

\*Source: Placer.ai

**SpeedWay Plaza**  
7730 Bruton Smith Blvd, Concord, NC 28...

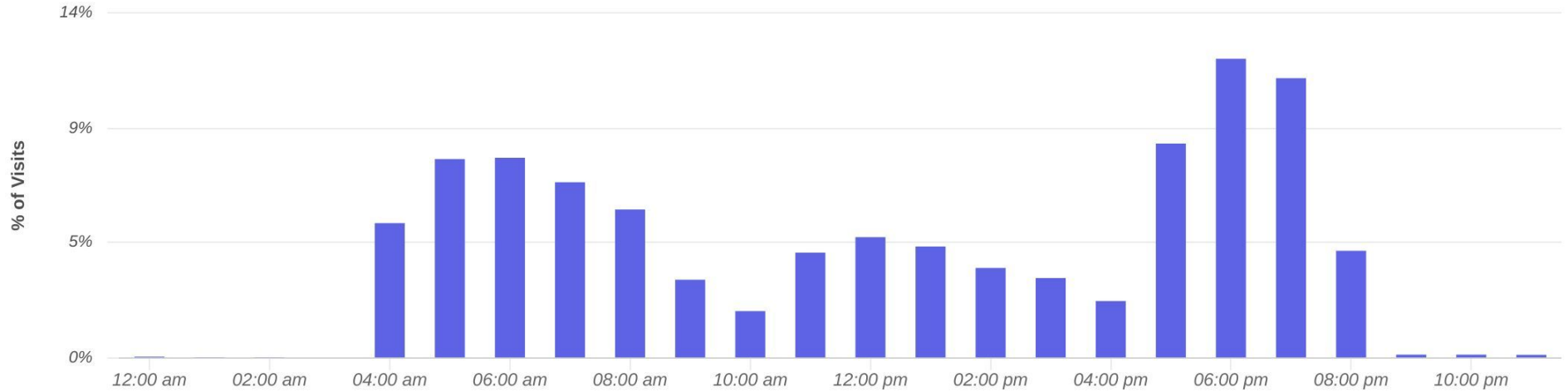

**Rebecca Herron**  
Director of  
Office & Industrial  
(704) 367 5017  
rherron@mpvre.com

**Robbie Adams**  
Director of Retail  
(704) 248 2108  
radams@mpvre.com

2400 South Boulevard | Suite 300  
Charlotte, NC 28203

[mpvre.com](http://mpvre.com)

# Speedway Plaza

7730 BRUTON SMITH BLVD, CONCORD, NC 28027

## Length of Stay

\*Source: Placer.ai

● **SpeedWay Plaza**  
7730 Bruton Smith Blvd, Concord, NC 28...

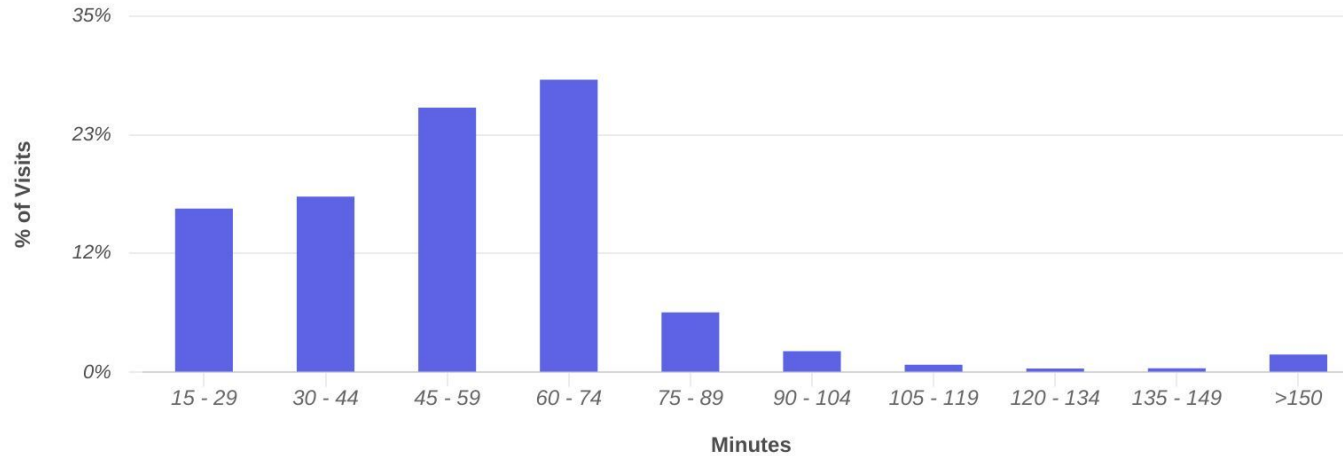

|              |        |
|--------------|--------|
| Average Stay | 56 min |
| Median Stay  | 54 min |



Rebecca Herron  
Director of  
Office & Industrial  
(704) 367 5017  
rherron@mpvre.com

Robbie Adams  
Director of Retail  
(704) 248 2108  
radams@mpvre.com

2400 South Boulevard | Suite 300  
Charlotte, NC 28203

mpvre.com





Working Together

Medical | Industrial | Retail | Land | Investment | Office

contact

**Rebecca Herron**  
*Director of*  
*Office & Industrial*  
(704) 367 5017  
rherron@mpvre.com

**Robbie Adams**  
*Director of Retail*  
(704) 248 2108  
radams@mpvre.com

2400 South Boulevard | Suite 300  
Charlotte, NC 28203

[mpvre.com](http://mpvre.com)