

# Wellman Building at 521

1041 RED VENTURES DRIVE, FORT MILL, SC 29707



Office

FOR

| Lease

SIZE

| ±35,247 SF

PRICE

| \$25.50 PSF



## Overview

±35,247 RSF available

Suite A: 3,874 RSF

Suite B: 5,328 RSF

Suite C: 26,045 RSF (can be subdivided)

---

Located in 521 Corporate Center

---

Excellent visibility with Highway 521 frontage

---

Immediate proximity to Ballantyne and south Charlotte amenities

---

First class office park and professional environment

---

\$25.50 PSF full service

---

Office Spaces For Lease at  
521 Corporate Center in  
Lancaster County, SC



Michael Bilodeau  
Development Partner

(704) 561 5253  
mbilodeau@mpvre.com

2400 South Boulevard | Suite 300  
Charlotte, NC 28203

[mpvre.com](http://mpvre.com)

# Wellman Building at 521

1041 RED VENTURES DRIVE, FORT MILL, SC 29707

## Property Overview

### Demographics

Source: Esri® 2023

	1 mile	3 mile	5 mile
Population	4,390	54,264	140,863
Growth Rate	21.71%	3.39%	1.99%
Avg. HH Income	\$130,286	\$170,647	\$159,428

### Traffic Count

Source: SCDOT

	AADT
Hwy 521	38,900 (2023)
Hwy 160	15,800 (2023)

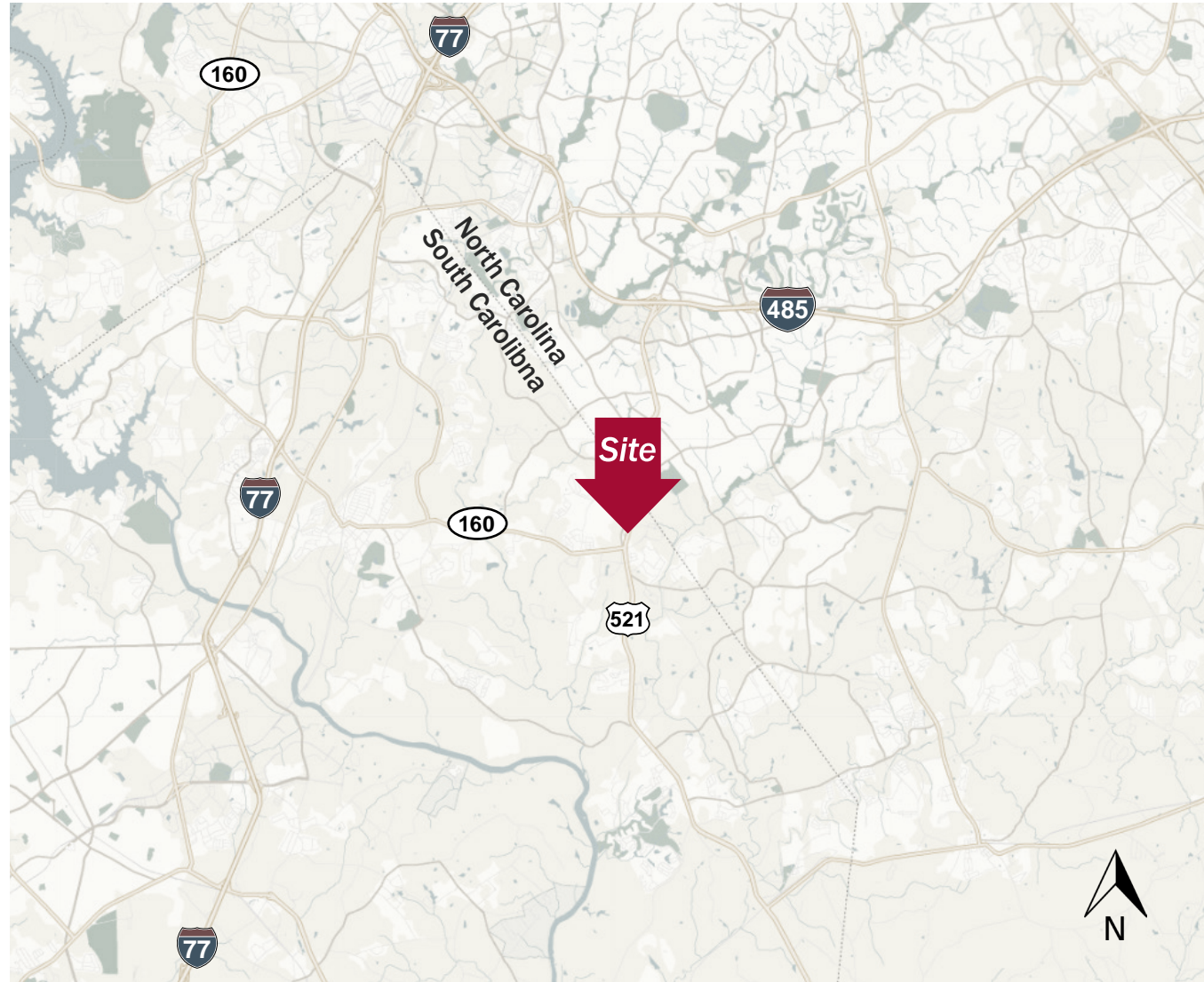

Michael Bilodeau  
Development Partner

(704) 561 5253  
mbilodeau@mpvre.com

2400 South Boulevard | Suite 300  
Charlotte, NC 28203

[mpvre.com](http://mpvre.com)

# Wellman Building at 521

1041 RED VENTURES DRIVE, FORT MILL, SC 29707

## Floor Plan

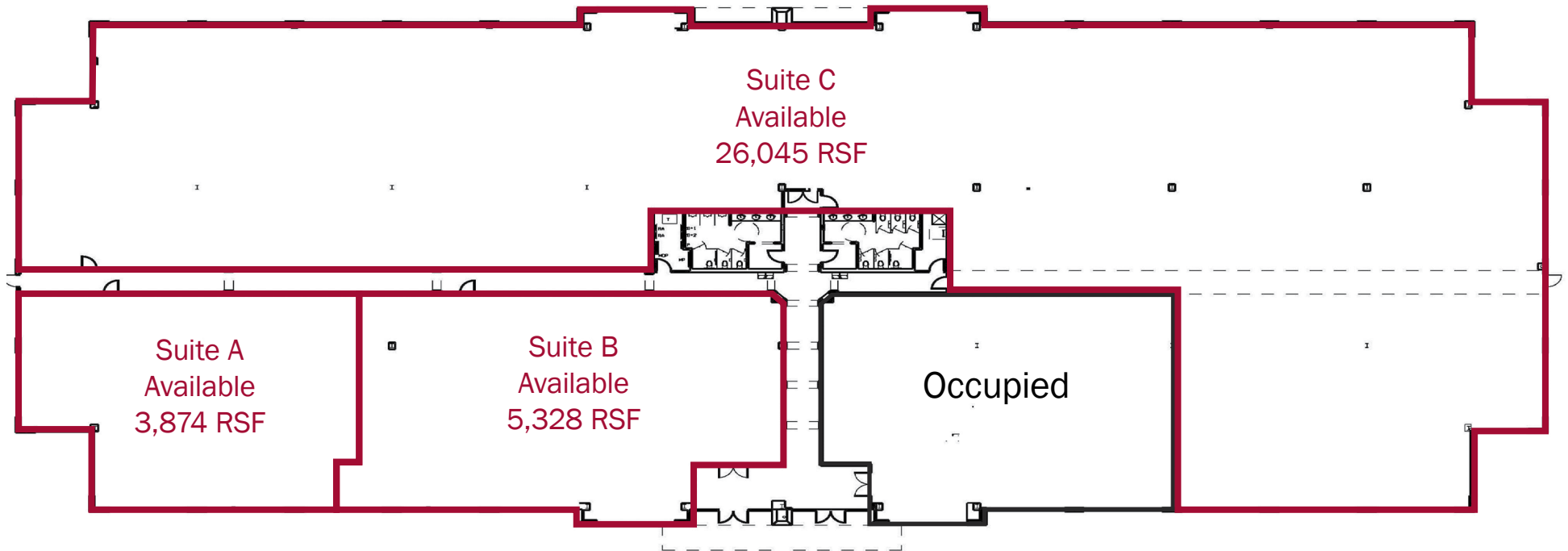

Michael Bilodeau  
Development Partner

(704) 561 5253  
mbilodeau@mpvre.com

2400 South Boulevard | Suite 300  
Charlotte, NC 28203

[mpvre.com](http://mpvre.com)



# Wellman Building at 521

1041 RED VENTURES DRIVE, FORT MILL, SC 29707

Market Aerial



Michael Bilodeau  
Development Partner

(704) 561 5253  
mbilodeau@mpvre.com

2400 South Boulevard | Suite 300  
Charlotte, NC 28203

mpvre.com





Working Together

Medical | Industrial | Retail | Land | Investment | Office

contact

**Michael Bilodeau**  
*Development Partner*  
(704) 561 5253  
mbilodeau@mpvre.com

2400 South Boulevard | Suite 300  
Charlotte, NC 28203

[mpvre.com](http://mpvre.com)