

Kellswater Commons Retail

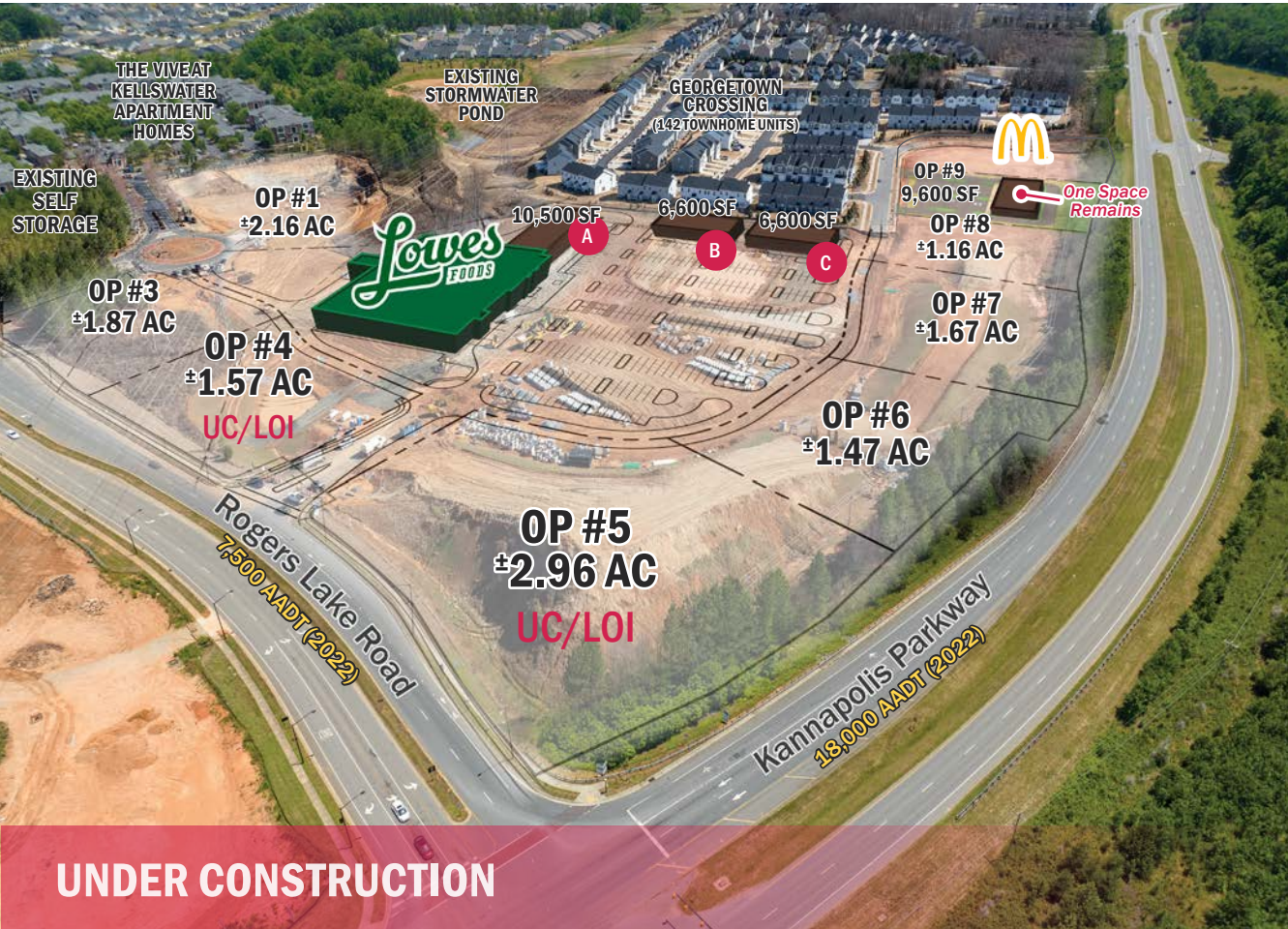

KANNAPOLIS PARKWAY & ROGERS LAKE ROAD, KANNAPOLIS, NC 28081

Retail	FOR	SIZE	OP SIZE	PRICE
	Lease	1,200–10,500 SF	1.16–2.96 Acres	Call for Pricing



Overview

Lowes grocery anchored shopping center; under construction - Delivers in early 2026

Retail and outparcel opportunities available

Part of Kellswater Bridge, a 370-acre residential development with capacity for up to 1,000 units

3 miles from the North Carolina Research Campus and convenient to UNCC and Uptown Charlotte

Located in fast-growing western Cabarrus County

Within Cabarrus County school system: Charles E. Boger Elementary, Northwest Cabarrus Middle, and Northwest Cabarrus High

Retail Space & Outparcels Available



Robbie Adams
Director of Retail
(704) 248 2108
radams@mpvre.com

Joey Morganthall
Director of Retail
(704) 367 5007
jmorganthall@mpvre.com

2400 South Boulevard | Suite 300
Charlotte, NC 28203

mpvre.com

Kellswater Commons Retail

KANNAPOLIS PARKWAY & ROGERS LAKE RD, KANNAPOLIS, NC 28081

Property Overview

Demographics

Source: Esri® 2024

	1 mile	3 mile	5 mile
Population	4,504	31,585	94,980
Growth Rate	10.69%	3.71%	2.50%
Avg. HH Income	\$155,719	\$99,650	\$99,690

Traffic Count

Source: NCDOT

	AADT
Rogers Lake Rd	7,500 (2023)
Kannapolis Blvd	20,000 (2024)

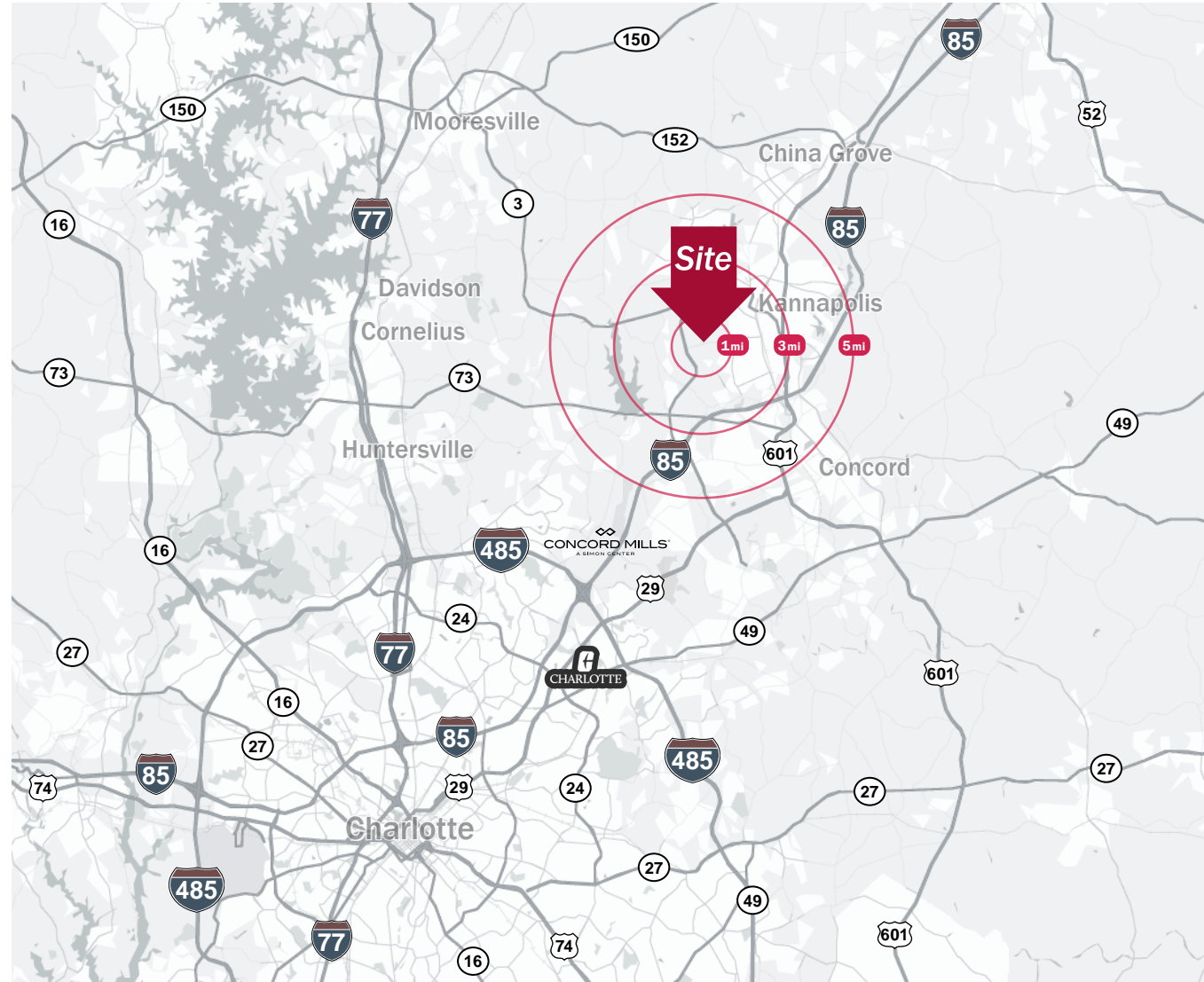

Robbie Adams
Director of Retail
(704) 248 2108
radams@mpvre.com

Joey Morganthall
Director of Retail
(704) 367 5007
jmorganthall@mpvre.com

2400 South Boulevard | Suite 300
Charlotte, NC 28203

mpvre.com

Kellswater Commons Retail

KANNAPOLIS PARKWAY & ROGERS LAKE RD, KANNAPOLIS, NC 28081

Overall Site Plan

Outparcel	Tenant
OP #1	AVAILABLE
OP #3	AVAILABLE
OP #4	LOI
OP #5A	LOI
OP #5B	LOI
OP #6	AVAILABLE
OP #7	AVAILABLE
OP #8	AVAILABLE
OP #9	AVAILABLE
OP #10	McDonalds

Key

- Available
- At Lease
- Leased

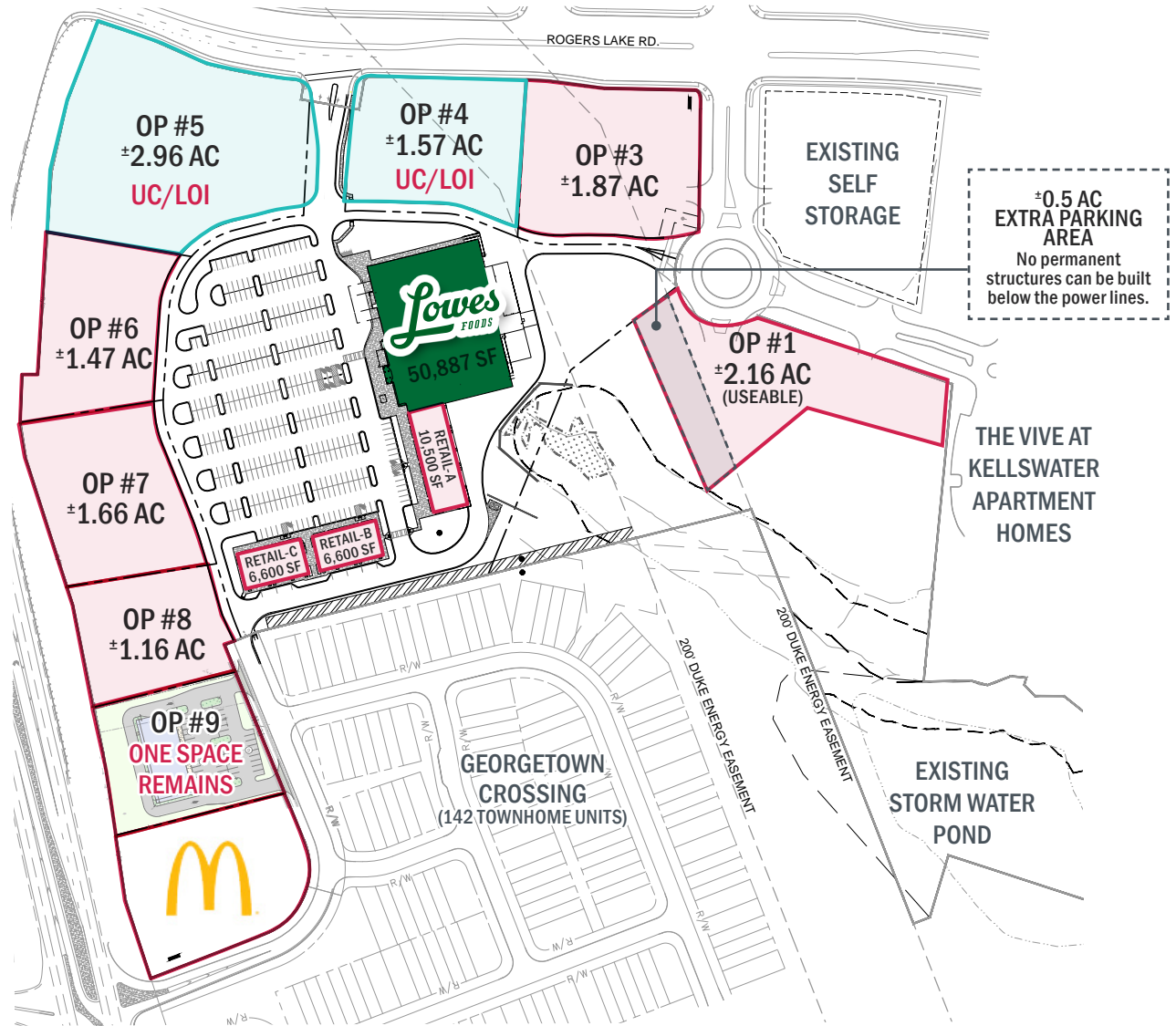

Robbie Adams
 Director of Retail
 (704) 248 2108
 radams@mpvre.com

Joey Morganthall
 Director of Retail
 (704) 367 5007
 jmorganthall@mpvre.com

2400 South Boulevard | Suite 300
 Charlotte, NC 28203

mpvre.com

Kellswater Commons Retail

KANNAPOLIS PARKWAY & ROGERS LAKE RD, KANNAPOLIS, NC 28081

Retail Shop Site Plan

Outparcel	Size
BLDG A	10,500 SF
BLDG B	6,600 SF
BLDG C	6,600 SF

Key

- Available
- At Lease
- Leased



Robbie Adams
Director of Retail
(704) 248 2108
radams@mpvre.com

Joey Morganthall
Director of Retail
(704) 367 5007
jmorganthall@mpvre.com

2400 South Boulevard | Suite 300
Charlotte, NC 28203

mpvre.com

Kellswater Commons Retail

KANNAPOLIS PARKWAY & ROGERS LAKE RD, KANNAPOLIS, NC 28081

Retail A Shop Site Plan

Suite	Size	Tenant
Suite 4927	1,380 SF	Great Clips
Suite 4929	2,520 SF	Avalon Spa & Nails
Suite 4933	1,200 SF	AVAILABLE
Suite 4935	1,500 SF	AVAILABLE
Suite 4937	1,485 SF	AVAILABLE
Suite 4941	2,415 SF	Burrito Shak

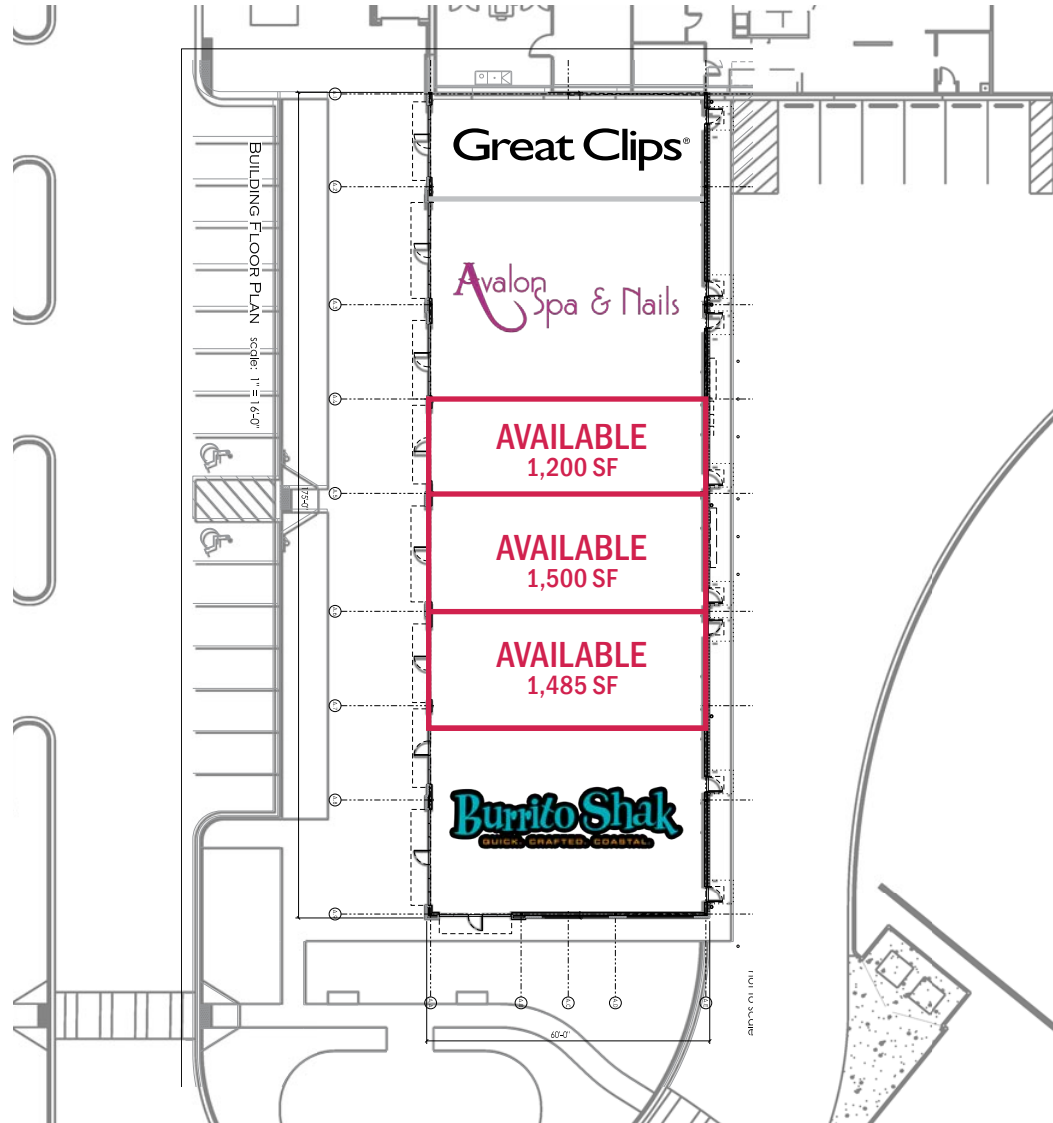

Robbie Adams
Director of Retail
(704) 248 2108
radams@mpvre.com

Joey Morganthall
Director of Retail
(704) 367 5007
jmorganthall@mpvre.com

2400 South Boulevard | Suite 300
Charlotte, NC 28203

mpvre.com

Kellswater Commons Retail

KANNAPOLIS PARKWAY & ROGERS LAKE RD, KANNAPOLIS, NC 28081

OP #9 Site Plan

Suite	Size	Tenant
Suite 5000	1,800 SF	Caribue Coffee
Suite 5004	2,500 SF	AVAILABLE
Suite 5006	1,500 SF	Jersey Mikes
Suite 5008	3,800 SF	Heartland Dental

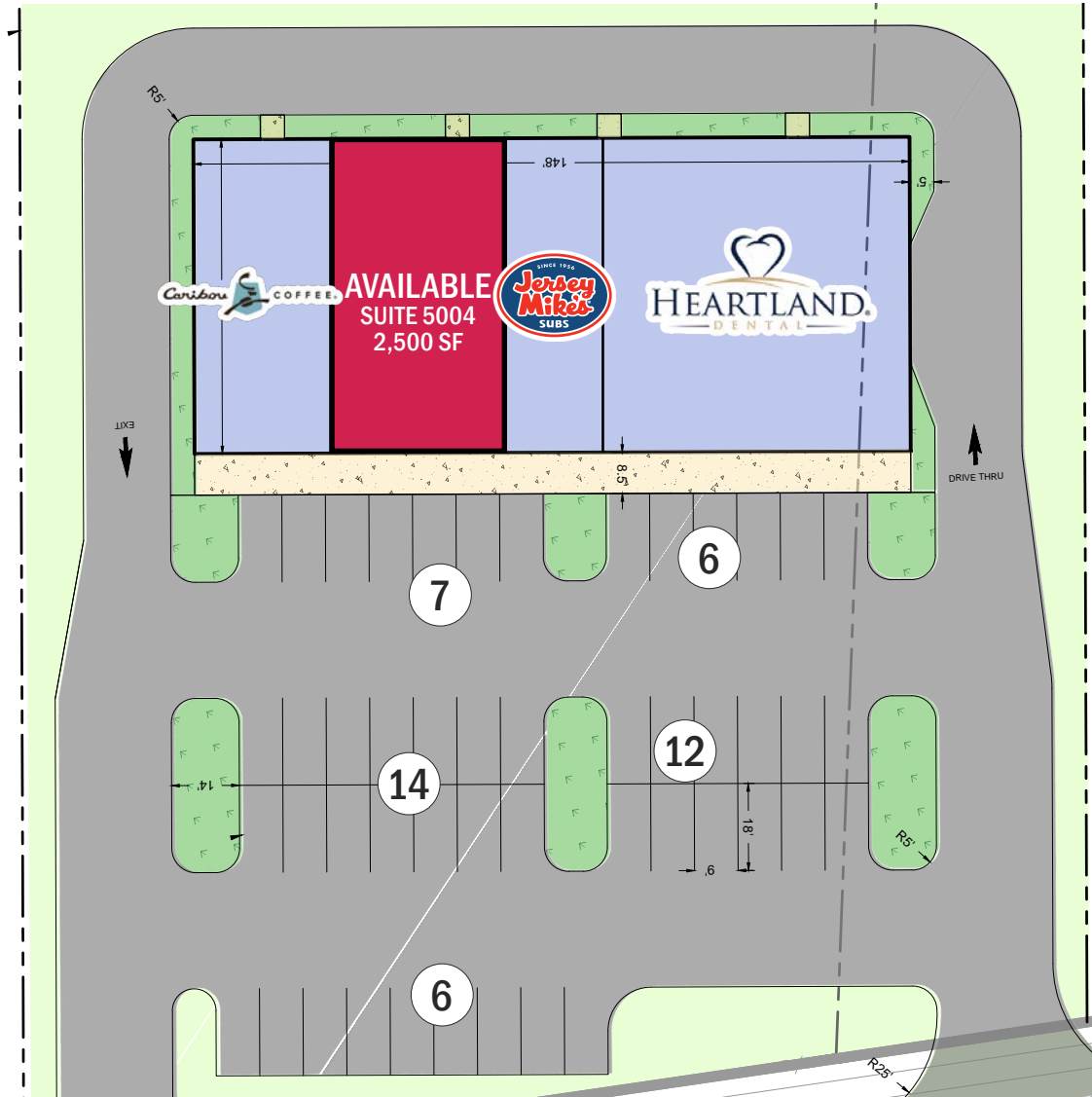

Robbie Adams
 Director of Retail
 (704) 248 2108
 radams@mpvre.com

Joey Morganthall
 Director of Retail
 (704) 367 5007
 jmorganthall@mpvre.com

2400 South Boulevard | Suite 300
 Charlotte, NC 28203

mpvre.com

Kellswater Commons Retail

KANNAPOLIS PARKWAY & ROGERS LAKE RD, KANNAPOLIS, NC 28081

Renderings



Robbie Adams
Director of Retail
(704) 248 2108
radams@mpvre.com

Joey Morganthall
Director of Retail
(704) 367 5007
jmorganthall@mpvre.com

2400 South Boulevard | Suite 300
Charlotte, NC 28203

mpvre.com

Kellswater Commons Retail

KANNAPOLIS PARKWAY & ROGERS LAKE RD, KANNAPOLIS, NC 28081



Robbie Adams
Director of Retail
(704) 248 2108
radams@mpvre.com

Joey Morganthall
Director of Retail
(704) 367 5007
jmorganthall@mpvre.com

2400 South Boulevard | Suite 300
Charlotte, NC 28203

mpvre.com

Kellswater Commons Retail

KANNAPOLIS PARKWAY & ROGERS LAKE RD, KANNAPOLIS, NC 28081

Residential Map

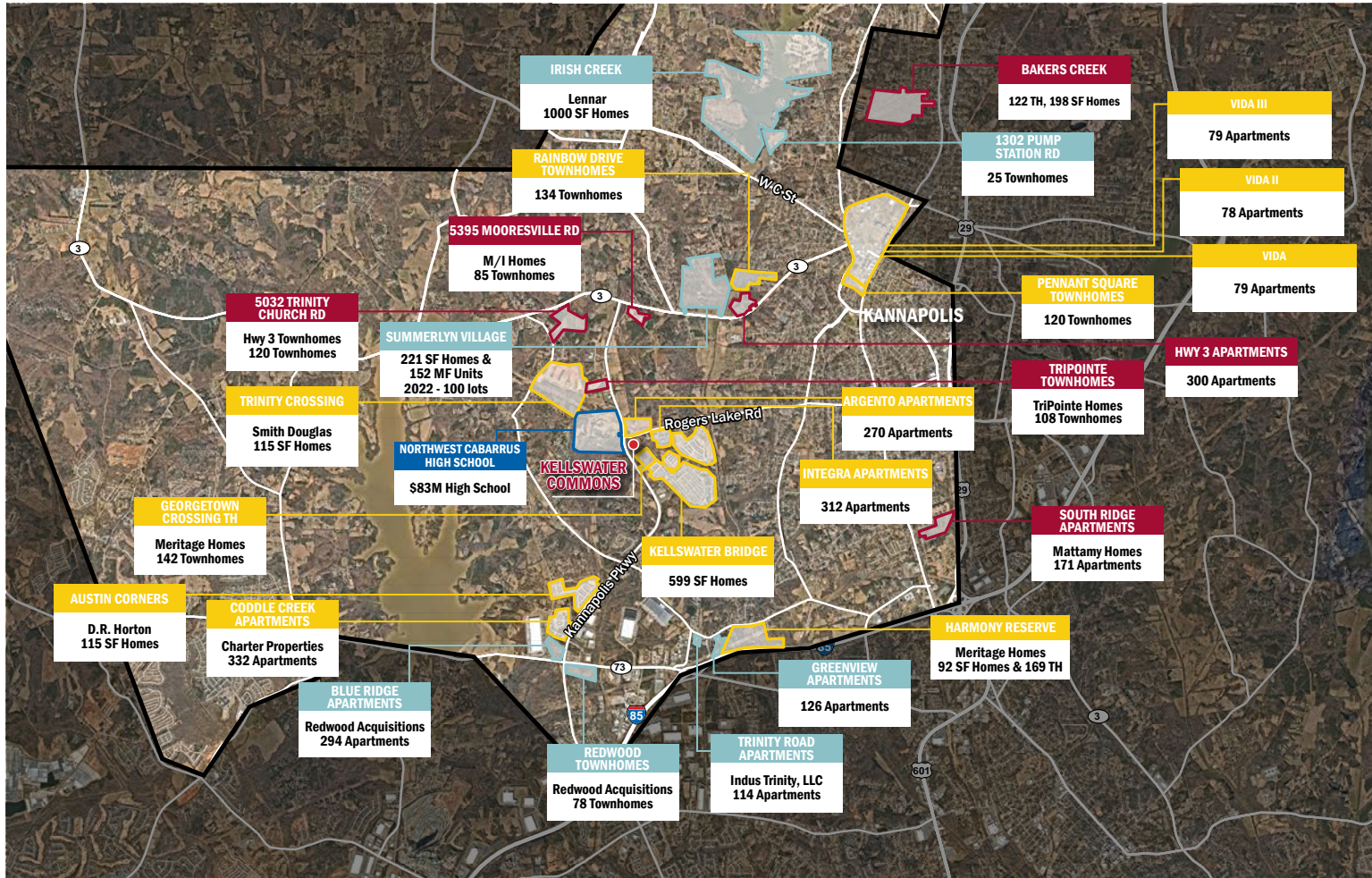

- FUTURE DEVELOPMENT: APPROVED
- FUTURE DEVELOPMENT: IN-REVIEW
- CITY PROJECT
- UNDER CONSTRUCTION



Robbie Adams
 Director of Retail
 (704) 248 2108
 radams@mpvre.com

Joey Morganthall
 Director of Retail
 (704) 367 5007
 jmorganthall@mpvre.com

2400 South Boulevard | Suite 300
 Charlotte, NC 28203

mpvre.com



Working Together

Medical | Industrial | Retail | Land | Investment | Office

contact

Robbie Adams
Director of Retail
(704) 248 2108
radams@mpvre.com

Joey Morganthall
Director of Retail
(704) 367 5007
jmorganthall@mpvre.com

2400 South Boulevard | Suite 300
Charlotte, NC 28203

mpvre.com